

Technical Data Sheet

Lync Storage Tank - LC Model

Lync's LC Model Storage Tanks are corrosion-resistant stainless steel storage solutions designed for long service life in commercial hot water systems. All-duplex stainless steel construction eliminates anode rods and supports elevated operating temperatures common in heat pump, solar thermal, and other energy-efficient applications. Optional outdoor coatings expand installation flexibility when mechanical room space is limited.

Features

- All-duplex stainless steel (LDX) tank construction
- No sacrificial anode rods required
- Suitable for high-temperature storage applications
- R-22 fiberglass insulation, exceeding ASHRAE 90.1 requirements
- Optional Rhino Lining® exterior coating for outdoor installations
- Integral inlet diffuser to promote thermal stratification
- Designed for compatibility with heat pump water heating systems

Long-Term Corrosion Protection

LC Model storage tanks utilize pickled and passivated duplex stainless steel, providing superior corrosion resistance over conventional glass-lined tanks. This construction supports reliable operation at elevated storage temperatures and eliminates the maintenance requirements of anode-based systems.

Thermal Performance

Each tank is wrapped with R-22 fiberglass insulation – approximately 75% higher than the ASHRAE 90.1 requirement for indoor storage tanks – minimizing standby heat loss while improving acoustic performance, fire resistance, and mildew protection.

Outdoor Installation Capability

For outdoor use in temperate climates, the optional 1/8-inch Rhino Lining coating creates a seamless protective barrier against moisture, abrasion, corrosion, and impact, allowing tanks to be installed outside to conserve valuable indoor mechanical room space.



Warranty

Advanced materials and manufacturing processes support an industry-leading 25-year limited tank corrosion warranty, underscoring the tank's long-term durability and lifecycle value.

Listings & Certifications

- ASME HLW
- ASHRAE 90.1
- ANSI / NSF 372



Dimensions

| Model | Storage gal. | Dimensions in inches | | | | | | | | | Water Inlet, Outlet, Return (NPT) | Approx. Shipping weight (lb) |
|---------|--------------|----------------------|-------|------|-------|----|----|-------|-------|-------|-----------------------------------|------------------------------|
| | | A | B | C | D | F | G | H | J | K | | |
| LC250S | 250 | 50 | 69.50 | 3.56 | 17.88 | 31 | 56 | 29.25 | 56.31 | 52.50 | 2-1/2" | 1000 |
| LC500S | 500 | 60.19 | 82.75 | 3.93 | 21.25 | 31 | 66 | 38.75 | 66.38 | 62.50 | 2-1/2" | 1600 |
| LC750S | 750 | 71 | 90.13 | 4.63 | 23.25 | 40 | 78 | 45.38 | 77.25 | 74.50 | 2-1/2" | 1875 |
| LC1000S | 1000 | 81.19 | 89.88 | 4.19 | 24.56 | 47 | 88 | 55 | 87.31 | 84.50 | 2-1/2" | 2900 |

Technical Specification

Maximum operating pressure 150 PSI (1034 kPa)
 Maximum water temperature 210°F (99°C)
 Listing/Compliance ASME HLW, ASHRAE 90.1, ANSI/NSF 372

1. Description Model No. LCXXXS (EX 500 gallon would be LC500S) LCXXXSO for outdoor models
2. Additional Dimensions:
 Jacket O.D. = +11 in to tank O.D.
 Base channels: +6 in to jacket (Pan) O.D. = 3 in each side
 Front nipples: stick out ~6.5 in past jacket
 Lifting and seismic lugs: ~+4 in above top pan
 Jacket Penetrations:
 I/O/R, drain, relief, 2 thermowells, ASME data plate (accessible)
 mounted on the front of the tank
 Back: Manway, process fitting (2 in) (both accessible)
 Thermowell diameter 1/4", allows for a 6mm probe.
 Connection 1/4" NPT.
 LC750S: 1 additional thermowell installed
 LC1000S: 2 additional thermowells installed
3. Tank supplied with Watts LF140X9. ASME relief capacity 3,085,000 BTU/hr @ 150 psi CSA relief capacity 670,000 BTU/hr

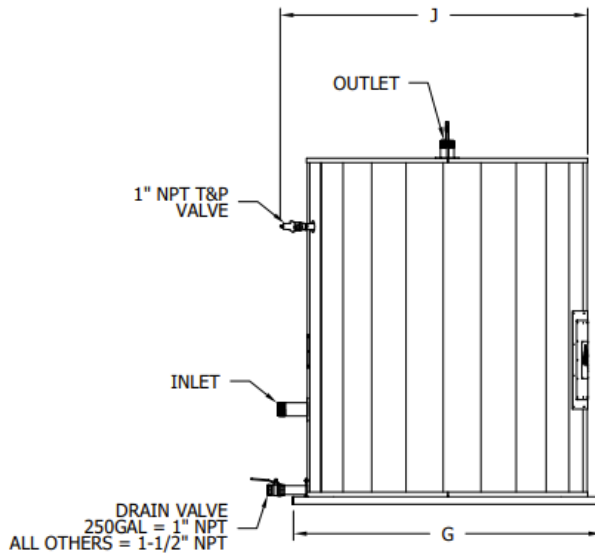
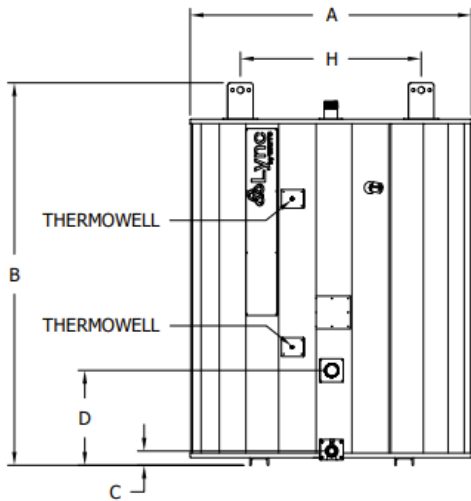
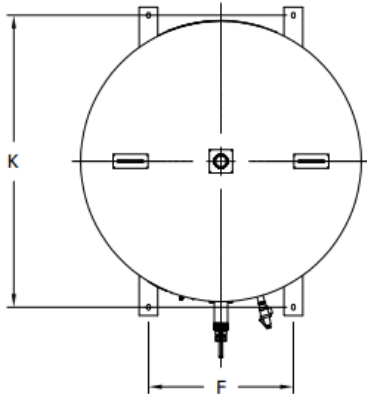

Engineered Solutions

Lync product specifications in U.S. customary units and metric are approximate and are provided for reference only. For precise measurements, please contact your local Lync Representative. Lync reserves the right to change or modify product design, construction, specifications, or materials without prior notice and without incurring any obligation to make such changes and modifications on Lync products previously or subsequently sold.

Fort Worth, TX • (817) 335-9531

6-3-2026 • © 2026 Lync